

# **MJ HYDRAULIC**

*Repairs and Maintenance*

## Quick Release Couplings & Live Swivel Joints



**MJ Hydraulic Repairs and Maintenance**  
**3/37 Grice Street, Clontarf, Queensland, 4019**  
**Ph: 0409 442 642 or 0419 578 318**  
**[www.mjhydraulic.com.au](http://www.mjhydraulic.com.au)**

**DISCLAIMER**

**Disclaimer**

The information and dimensions listed in these catalogues is correct to the best of our knowledge and belief, having been compiled from reliable and official sources of information. MJ Hydraulic Repairs and Maintenance accepts no responsibility for possible errors, omissions or unsuitable parts being listed or fitted to any vehicle. Dimensions listed are nominal throughout. Due to our continuous product and range development we reserve the right to alter the specification without prior notice.

We welcome any feedback re suspected errors or omissions to the information enclosed.

We can be contacted via email [info@mjhydraulic.com.au](mailto:info@mjhydraulic.com.au)

Or via fax 07 3284 9233.

Alternatively via mail at 3/37 Grice Street, Clontarf, Queensland, 4019.

Quick Release Couplings

[www.mjhydraulic.com.au](http://www.mjhydraulic.com.au)

Document No:	HSHYDCAT
Issue:	3
Issue Date:	01/09/2016

This catalogue is the copyright of HS Company Pty. Ltd.

# QR COUPLINGS

## CONTENTS

DESCRIPTION:

QUICK RELEASE COUPLINGS .....	D:6-2
QUICK RELEASE COUPLING SEAL KITS .....	D:6-7
QUICK RELEASE COUPLINGS - INDUSTRIAL .....	D:6-8
QUICK RELEASE COUPLING CAPS & PLUGS .....	D:6-9
AIR LINE COUPLINGS .....	D:6-11
TAIMI LIVE SWIVELS .....	D:6-13
TAIMI LIVE SWIVEL CARTRIDGES .....	D:6-16
INTERTRACO LIVE SWIVELS .....	D:6-17
TAIMI TENSIONER .....	D:6-18
TAIMI TENSIONER SPANNER .....	D:6-18
TAIMI CIRCULAR & SPHERICAL JOINTS .....	D:6-19
TAIMI MANIFOLDS .....	D:6-20

[www.mjhydraulic.com.au](http://www.mjhydraulic.com.au)

Document No:	HSHYDCAT
Issue:	3
Issue Date:	01/09/2016

This catalogue is the copyright  
of HS Company Pty. Ltd.

## QR COUPLINGS

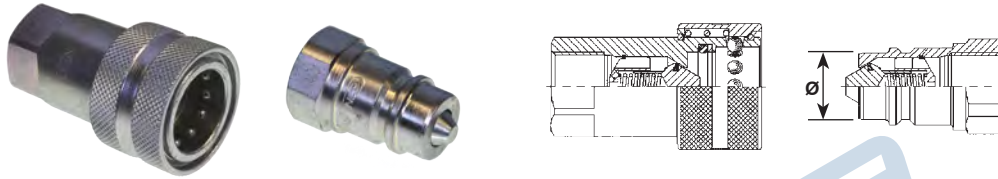

### ISO 7241-1 Type A

FEMALE PART NUMBER	MALE PART NUMBER	NOMINAL SIZE	TIP Ø (mm)	THREAD SIZE P - BSPP	RATED FLOW (lpm)	MAXIMUM OPERATING PRESSURE (Bar)	PRESSURE DROP AT RATED FLOW (Bar)
F-ISOA-04-04-P (103951202)	M-ISOA-04-04-P (103956202)	1/4" (6.3)	11.8	1/4"	12	350	5.5
F-ISOA-06-06-P (104951204)	M-ISOA-06-06-P (104956204)	3/8" (10)	17.2	3/8"	23	300	0.8
F-ISOA-08-08-P (105951205)	M-ISOA-08-08-P (105956205)	1/2" (12.5)	20.5	1/2"	45	250	1.3
F-ISOA-12-12-P (106951201)	M-ISOA-12-12-P (106956201)	3/4" (20)	29	3/4"	74	250	0.9
F-ISOA-16-16-P (107951203)	M-ISOA-16-16-P (107956203)	1" (25)	34.3	1"	100	230	0.75

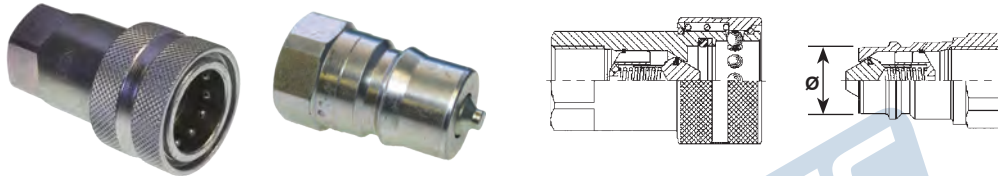

### ISO 7241-1 Type B

FEMALE PART NUMBER	MALE PART NUMBER	NOMINAL SIZE	TIP Ø (mm)	THREAD SIZE P - BSPP N - NPT	RATED FLOW (lpm)	MAXIMUM OPERATING PRESSURE (Bar)	PRESSURE DROP AT RATED FLOW (Bar)
F-ISOB-04-04-N (103751402)	M-ISOB-04-04-N (103756402)	1/4" (6.3)	14.1	1/4"	12	350	1.8
F-ISOB-04-04-P (103751202)	M-ISOB-04-04-P (103756202)	1/4" (6.3)	14.1	1/4"	12	350	1.8
F-ISOB-06-06-N (104751404)	M-ISOB-06-06-N (104756404)	3/8" (10)	19	3/8"	23	300	0.7
F-ISOB-08-08-N (105751405)	M-ISOB-08-08-N (104756405)	1/2" (12.5)	23.5	3/8"	45	250	1.0
F-ISOB-08-08-P (105751205)	M-ISOB-08-08-P (105756205)	1/2" (12.5)	23.5	1/2"	45	250	1.0
F-ISOB-12-12-N (106751401)	M-ISOB-12-12-N (107756401)	3/4" (20)	31.4	3/4"	74	250	0.65
F-ISOB-12-12-P (106751201)	M-ISOB-12-12-P (107756201)	3/4" (20)	31.4	3/4"	74	250	0.65
F-ISOB-16-16-N (107751403)	M-ISOB-16-16-N (107756403)	1" (25)	37.8	1"	100	230	0.5
F-ISOB-16-16-P (107751203)	M-ISOB-16-16-P (107756203)	1" (25)	37.8	1"	100	230	0.5

¥ Pricing & availability on request. Minimum purchase quantity may apply.

www.mjhydraulic.com.au

Document No:	HSHYDCAT
Issue:	3
Issue Date:	01/09/2016

## QR COUPLINGS

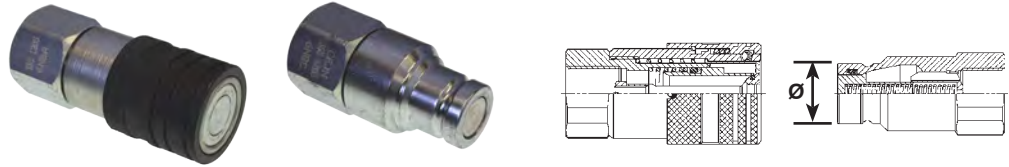

### ISO 16028 Flat Face

FEMALE PART NUMBER	MALE PART NUMBER	NOMINAL SIZE	TIP Ø (mm)	THREAD SIZE P - BSPP	RATED FLOW (lpm)	MAXIMUM OPERATING PRESSURE (Bar)	PRESSURE DROP AT RATED FLOW (Bar)
F-FF-04-04-P (102651202)	M-FF-04-04-P (102656202)	1/4" (6.3)	16.15	1/4"	12	500	1.0
F-FF-06-06-P (103651204)	M-FF-06-06-P (103656204)	3/8" (10.0)	19.7	3/8"	23	400	1.0
F-FF-06-08-P (103651205)	M-FF-06-08-P (103656205)	3/8" (10.0)	19.7	1/2"	23	400	1.0
F-FF-08-08-P (105651205)	M-FF-08-08-P (105656205)	1/2" (12.5)	24.5	1/2"	45	400	1.0
F-FF-08-12-P (105651207)	M-FF-08-12-P (105656207)	1/2" (12.5)	24.5	3/4"	45	400	1.0
F-FF-10-12-P (106651201)	M-FF-10-12-P (106656201)	5/8" (16.0)	27.0	3/4"	74	400	1.0
F-FF-12-12-P (107651201)	M-FF-12-12-P (107656201)	3/4" (19.0)	29.9	3/4"	100	400	1.0
F-FF-12-16-P (107651203)	M-FF-12-16-P (107656203)	3/4" (19.0)	29.9	1"	100	400	1.0
F-FF-16-16-P (100651203)	M-FF-16-16-P (100656203)	1" (24.4)	36.0	1"	189	300	1.0



### ISO 16028 Flat Face - Pressure Eliminator

FEMALE PART NUMBER	MALE PART NUMBER	NOMINAL SIZE	TIP Ø (mm)	THREAD SIZE P - BSPP U - UNO	RATED FLOW (lpm)	MAXIMUM OPERATING PRESSURE (Bar)	PRESSURE DROP AT RATED FLOW (Bar)
F-FF-06-06-P (103651204)	M-FF-06-06-P-E (103646204)	3/8" (10.0)	19.7	3/8"	23	400	1.0
F-FF-06-08-P (103651205)	M-FF-06-08-P-E (103646205)	3/8" (10.0)	19.7	1/2"	23	400	1.0
F-FF-08-08-P (105651205)	M-FF-08-08-P-E (105646205)	1/2" (12.5)	24.5	1/2"	45	400	1.0
F-FF-12-12-P (107651201)	M-FF-12-12-P-E (107646201)	3/4" (19.0)	29.9	3/4"	105	400	1.0
F-FF-06-12-U (1033651605)	M-FF-06-12-U-E (103646605)	3/8" (10.0)	19.7	3/4"	23	400	1.0
F-FF-08-14-U (105651606)	M-FF-08-14-U-E (105646607)	1/2" (12.5)	24.5	7/8"	45	400	1.0
F-FF-08-17-U (105651607)	M-FF-08-17-U-E (OF-564-104431)	1/2" (12.5)	24.5	1 1/16"	45	400	1.0
F-FF-10-17-U (106651601)	M-FF-10-17-U-E (OF-664-113517)	5/8" (16.0)	27.0	1 1/16"	70	400	1.0
F-FF-12-21-U (107651603)	M-FF-12-21-U-E (OF-764-104435)	3/4" (19.0)	29.9	1 5/16"	105	400	1.0

www.mjhydraulic.com.au

Document No:	HSHYDCAT
Issue:	3
Issue Date:	01/09/2016

¥ Pricing & availability on request. Minimum purchase quantity may apply.

## QR COUPLINGS

### PBR Style Hydraulic Coupling (for INDUSTRIAL application)

These units are designed to be used as a means of connecting a hose to a hydraulic oil supply, allowing quick and easy disconnecting without loss of oil. They also prevent air entering the system when reconnecting.



### PBR Interchange Series Coupling

FEMALE PART NUMBER	MALE PART NUMBER	NOMINAL SIZE	TIP Ø (mm)	THREAD SIZE P - BSPP	RATED FLOW (lpm)	MAXIMUM OPERATING PRESSURE (Bar)	PRESSURE DROP AT RATED FLOW (Bar)
F-PBR-16-16-P (PBR-16F)	M-PBR-16-16-P (PBR-16M)	1" (25)	38.4	1"	200	300	1.5

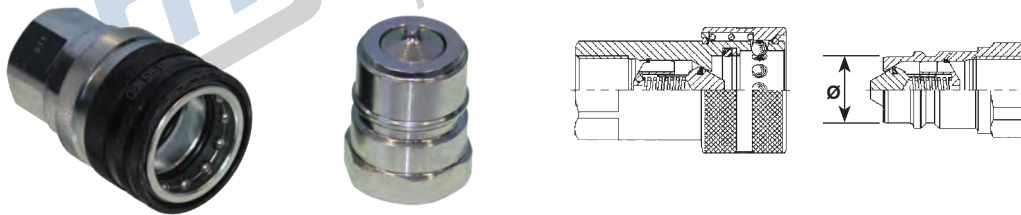

### Nordic (Tema) Style Couplings

FEMALE PART NUMBER	MALE PART NUMBER	NOMINAL SIZE	TIP Ø (mm)	THREAD SIZE P - BSPP	RATED FLOW (lpm)	MAXIMUM OPERATING PRESSURE (Bar)	PRESSURE DROP AT RATED FLOW (Bar)
F-NOR-04-04-P (105251202)	M-NOR-04-04-P (105256202)	1/4" (6.3)	12.0	1/4"	29	450	4.0
F-NOR-06-06-P (105251204)	M-NOR-06-06-P (105256204)	3/8" (10)	19.9	3/8"	69	350	4.0
F-NOR-08-08-P (105251205)	M-NOR-08-08-P (105256205)	1/2" (12.5)	24.7	1/2"	122	300	4.0
F-NOR-12-12-P (105251207)	M-NOR-12-12-P (105256207)	3/4" (20.0)	32.7	3/4"	250	280	4.0
F-NOR-16-16-P (105251209)	M-NOR-16-16-P (105256209)	1" (25.0)	40.9	1"	425	250	4.0

### Nordic (Tema) Style Couplings - Pressure Eliminator

FEMALE PART NUMBER	MALE PART NUMBER	NOMINAL SIZE	TIP Ø (mm)	THREAD SIZE P - BSPP	RATED FLOW (lpm)	MAXIMUM OPERATING PRESSURE (Bar)	PRESSURE DROP AT RATED FLOW (Bar)
F-NOR-12-12-P-E (105251207)	M-NOR-12-12-P-E (105256207)	3/4" (20.0)	32.7	3/4"	250	280	4.0
F-NOR-16-16-P-E (105251209)	M-NOR-16-16-P-E (105256209)	1" (25.0)	40.9	1"	425	250	4.0

¥ Pricing & availability on request. Minimum purchase quantity may apply.

Quick Release Couplings

www.mjhydraulic.com.au

Document No:	HSHYDCAT
Issue:	3
Issue Date:	01/09/2016

## QR COUPLINGS



### TLX Series Couplings

FEMALE PART NUMBER	MALE PART NUMBER	NOMINAL SIZE	THREAD SIZE P - BSPP N - NPT	RATED FLOW (lpm)	MAXIMUM OPERATING PRESSURE (Bar)	PRESSURE DROP AT RATED FLOW (Bar)
F-TLX-12-12-P (106071301)	M-TLX-12-12-P (106076301)	3/4" (20)	3/4"	160	400	
F-TLX-12-12-N (106071401)	M-TLX-12-12-N (106076401)	3/4" (20)	3/4"	160	400	
F-TLX-16-16-P (107071203)	M-TLX-16-16-P (107076203)	1" (10)	1"	285	400	
F-TLX-16-16-N (107071403)	M-TLX-16-16-N (107076403)	1" (12.5)	1"	285	400	
F-TLX-20-20-P (108071204)	M-TLX-20-20-P (108076204)	1 1/4" (32)	1 1/4"	400	400	
F-TLX-20-20-N (108071404)	M-TLX-20-20-N (108076404)	1 1/4" (32)	1 1/4"	400	400	
F-TLX-24-24-P (108071205)	M-TLX-24-24-P (108076205)	1 1/2" (38)	1 1/2"			



### HPJ Series - 700 Bar Jacking

FEMALE PART NUMBER	MALE PART NUMBER	NOMINAL SIZE	TIP Ø (mm)	THREAD SIZE N - NPTF	RATED FLOW (lpm)	MAXIMUM OPERATING PRESSURE (Bar)	BURST PRESSURE COUPLED (Bar)
F-HPJ-04-04-N	M-HPJ-04-04-N	3/16" (5)	15.8	1/4"	12	700	2500
F-HPJ-06-06-N	M-HPJ-06-06-N	1/4" (6.3)	19	3/8"	23	700	2350

Also available in poppet style.

www.mjhydraulic.com.au

Document No:	HSHYDCAT
Issue:	3
Issue Date:	01/09/2016

¥ Pricing & availability on request. Minimum purchase quantity may apply.

## QR COUPLINGS



### Agricultural Style (Ball Type)

FEMALE PART NUMBER	MALE PART NUMBER	NOMINAL SIZE	TIP Ø (mm)	THREAD SIZE P - BSPP	RATED FLOW (lpm)	MAXIMUM OPERATING PRESSURE (Bar)	PRESSURE DROP AT RATED FLOW (Bar)
F-AGB-04-04-P (PDS1.0606.002)	M-AGB-04-04-P (PDS1.0606.003)	1/4" (6.3)	14	1/4"	11	300	2.5
F-AGB-06-06-P (PDS1.1010.002)	M-AGB-06-06-P (PDS1.1010.003)	3/8" (10)	19	3/8"	21	250	2.0
F-AGB-08-08-P (PDS1.1313.002)	M-AGB-08-08-P (PDS1.1313.003)	1/2" (12.5)	21	1/2"	30	200	1.4
F-AGB-12-12-P (PDS1.2019.002)	M-AGB-12-12-P (PDS1.2019.003)	3/4" (20)	28	3/4"	60	200	1.4
F-AGB-16-16-P (PDS1.2525.002)	M-AGB-16-16-P (PDS1.2525.003)	1" (25)	31	1"	80	200	1.2



### Agricultural Style (Poppet Type)

FEMALE PART NUMBER	MALE PART NUMBER	NOMINAL SIZE	TIP Ø (mm)	THREAD SIZE P - BSPP	RATED FLOW (lpm)	MAXIMUM OPERATING PRESSURE (Bar)	PRESSURE DROP AT RATED FLOW (Bar)
F-AGP-04-04-P (PDV1.0606.002)	M-AGP-04-04-P (PDV1.0606.003)	1/4" (6.3)	14	1/4"	12	400	1.1
F-AGP-06-06-P (PDV1.1010.002)	M-AGP-06-06-P (PDV1.1010.003)	3/8" (10)	19	3/8"	23	350	0.5
F-AGP-08-08-P (PDV1.1313.002)	M-AGP-08-08-P (PDV1.1313.003)	1/2" (12.5)	21	1/2"	45	250	1.1
F-AGP-12-12-P (PDV1.2019.002)	M-AGP-12-12-P (PDV1.2019.003)	3/4" (20)	28	3/4"	106	250	1.9
F-AGP-16-16-P (PDV1.2525.002)	M-AGP-16-16-P (PDV1.2525.003)	1" (25)	31	1"	189	250	2.5

¥ Pricing & availability on request. Minimum purchase quantity may apply.

www.mjhydraulic.com.au

Document No:	HSHYDCAT
Issue:	3
Issue Date:	01/09/2016



**QR COUPLINGS**



**FF Series Seal Kits**

DN SIZE	NBR SEAL KIT PART NUMBER	SUIT MALE COUPLING		
6.3	102654900 ¥	M-FF-04-04-P		
10	103654900 ¥	M-FF-06-06-P		
12.5	105654900 ¥	M-FF-08-08-P		
16	106654900 ¥	M-FF-10-12-P		
19	107654900 ¥	M-FF-12-16-P		



**Nordic Series Seal Kits**

DIN SIZE	NBR SEAL KIT PART NUMBER	SUIT COUPLING		
6.3	105254900 ¥	F-NOR-04-04-P		
10	105254901 ¥	F-NOR-06-06-P		
12.5	105254902 ¥	F-NOR-08-08-P		
20	105254903	F-NOR-12-12-P		
25	105254904	F-NOR-16-16-P		

www.mjhydraulic.com.au

Document No:	HSHYDCAT
Issue:	3
Issue Date:	01/09/2016

¥ Pricing & availability on request. Minimum purchase quantity may apply.  
Note: Seal kits listed above are for CEJN brand of coupling.

## QR COUPLINGS

### PB3310 Hydraulic Coupling (for INDUSTRIAL application)

These units are designed to be used as a means of connecting a hose to a hydraulic oil supply, allowing quick and easy disconnecting without loss of oil. They also prevent air entering the system when reconnecting.



### PB3310 Series Coupling

FEMALE PART NUMBER	MALE PART NUMBER	NOMINAL SIZE	TIP Ø (mm)	THREAD SIZE P - BSPP	RATED FLOW (lpm)	MAXIMUM OPERATING PRESSURE (Bar)	PRESSURE DROP AT RATED FLOW (Bar)
PB-3310-29	PB3310-22	1" (25)	38.1	1"	200	300	1.5



### PB3310 Series Dust Covers

NOMINAL SIZE BSPT	CAP PART NUMBER	SUIT MALE COUPLING	PLUG PART NUMBER	SUIT FEMALE COUPLING
1"	PB3310-12	PB3310-22	PB3310-11	PB3310-29

**Important note:**

Seal kits only suit the original PBR couplings.

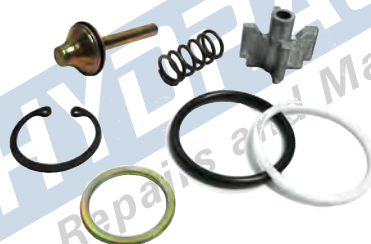

### REPAIR KITS: (Component parts not sold separately)

Repair Kit No.		10904	10905		
Suits		PB3310-22	PB3310-29		
Consists Of	No. Off				
'O' Ring	1	-	OR130027		
Washer	1	PB3310-25	PB3310-25		
Washer	1	PB3310-30	PB3310-30		
Valve Spindle	1	PB3310-32	PB3310-32		
Valve Guide	1	PB3310-4	PB3310-4		
Ring	1	PB3310-31	PB3310-31		
Circlip	1	SIC-1.187	SIC-1.187		
Spring	1	PB3310-6	PB3310-6		

www.mjhydraulic.com.au

Document No:	HSHYDCAT
Issue:	3
Issue Date:	01/09/2016

**QR COUPLINGS**

**COUPLING DUST CAPS AND PLUGS**



**ISOA Series**

NOMINAL SIZE BSPP	CAP PART NUMBER	SUIT MALE COUPLING	PLUG PART NUMBER	SUIT FEMALE COUPLING
1/4"	DC-ISOA-04	M-ISOA-04-04-P	DP-ISOA-04	F-ISOA-04-04-P
3/8"	DC-ISOA-06	M-ISOA-06-06-P	DP-ISOA-06	F-ISOA-06-06-P
1/2"	DC-ISOA-08	M-ISOA-08-08-P	DP-ISOA-08	F-ISOA-08-08-P
3/4"	DC-ISOA-12	M-ISOA-12-12-P	DP-ISOA-12	F-ISOA-12-12-P
1"	DC-ISOA-16	M-ISOA-16-16-P	DP-ISOA-16	F-ISOA-16-16-P



**FF Series**

NOMINAL SIZE BSPP	CAP PART NUMBER	SUIT MALE COUPLING	PLUG PART NUMBER	SUIT FEMALE COUPLING
1/4"	DC-FF-04	M-FF-04-04-P	DP-FF-04	F-FF-04-04-P
3/8"	DC-FF-06	M-FF-06-06-P	DP-FF-06	F-FF-06-06-P
3/8"	DC-FF-06	M-FF-06-08-P	DP-FF-06	F-FF-06-08-P
1/2"	DC-FF-08	M-FF-08-08-P	DP-FF-08	F-FF-08-08-P
1/2"	DC-FF-08	M-FF-08-12-P	DP-FF-08	F-FF-08-12-P
3/4"	DC-FF-12	M-FF-10-12-P	DP-FF-12	F-FF-10-12-P
1"	DC-FF-16	M-FF-12-16-P	DP-FF-16	F-FF-12-16-P



**HPJ Series**

NOMINAL SIZE NPT	CAP PART NUMBER	SUIT MALE COUPLING	PLUG PART NUMBER	SUIT FEMALE COUPLING
1/4"	DC-HPJ-04	M-HPJ-04-04-N	DP-HPJ-04	F-HPJ-04-04-N
3/8"	DC-HPJ-06	M-HPJ-06-06-N	DP-HPJ-06	F-HPJ-06-06-N

www.mjhydraulic.com.au

Document No:	HSHYDCAT
Issue:	3
Issue Date:	01/09/2016

This catalogue is the copyright of HS Company Pty. Ltd.

## QR COUPLINGS

### COUPLING DUST CAPS AND PLUGS



#### Nordic Series

NOMINAL SIZE BSPP	CAP PART NUMBER	SUIT MALE COUPLING	PLUG PART NUMBER	SUIT FEMALE COUPLING
1/4"	DC-NOR-04	M-NOR-04-04-P	DP-NOR-04	F-NOR-04-04-P
3/8"	DC-NOR-06	M-NOR-06-06-P	DP-NOR-06	F-NOR-06-06-P
1/2"	DC-NOR-08	M-NOR-08-08-P	DP-NOR-08	F-NOR-08-08-P
3/4"	DC-NOR-12	M-NOR-12-12-P	DP-NOR-12	F-NOR-12-12-P
1"	DC-NOR-16	M-NOR-16-16-P	DP-NOR-16	F-NOR-16-16-P



#### TLX Series Caps & Plugs

NOMINAL SIZE BSPP	CAP PART NUMBER	SUIT MALE COUPLING	PLUG PART NUMBER	SUIT FEMALE COUPLING
3/4"	DC-TLX-12	M-TLX-12-12-P	DP-TLX-12	F-TLX-12-12-P
1"	DC-TLX-16	M-TLX-16-16-P	DP-TLX-16	F-TLX-16-16-P
1 1/4"	DC-TLX-20	M-TLX-20-20-P	DP-TLX-20	F-TLX-20-20-P
1 1/2"	DC-TLX-24	M-TLX-24-24-P	DP-TLX-24	F-TLX-24-24-P

Note: The above caps and plugs also suit the TLX NPT range of couplings

¥ Pricing & availability on request. Minimum purchase quantity may apply.

www.mjhydraulic.com.au

Document No:	HSHYDCAT
Issue:	3
Issue Date:	01/09/2016

## AIR COUPLINGS

### NITTO AIR LINE COUPLINGS



Figure 1



Figure 2



Figure 3

### MALE PLUGS

Part Number		Figure	Thread Details		Hose Size	Notes
Standard	200 Series		Size	Type		
20PM	-	1	1/4"	BSP - Male	-	
20PF	-	2	1/4"	BSP - Female	-	
20PH	-	3	-	-	1/4"	
30PM	-	1	3/8"	BSP - Male	-	
30PF	-	2	3/8"	BSP - Female	-	
30PH	-	3	-	-	3/8"	
40PM	-	1	1/2"	BSP - Male	-	
40PF	-	2	1/2"	BSP - Female	-	
40PH	-	3	-	-	1/2"	



Figure 4



Figure 5



Figure 6



Standard Series

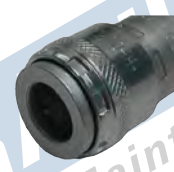

1 Touch 200 Series

### FEMALE COUPLERS

Part Number		Figure	Thread Details		Hose Size	Notes
Standard	200 Series		Size	Type		
20SM	200-20SM	4	1/4"	BSP - Male	-	
20SF	200-20SF	5	1/4"	BSP - Female	-	
20SH	200-20SH	6	-	-	1/4"	
30SM	200-30SM	4	3/8"	BSP - Male	-	
30SF	200-30SF	5	3/8"	BSP - Female	-	
30SH	200-30SH	6	-	-	3/8"	
40SM	200-40SM	4	1/2"	BSP - Male	-	
40SF	200-40SF	5	1/2"	BSP - Female	-	
40SH	200-40SH	6	-	-	1/2"	

¥ Pricing & availability on request. Minimum purchase quantity may apply.

www.mjhydraulic.com.au

Document No:	HSHYDCAT
Issue:	3
Issue Date:	01/09/2016

This catalogue is the copyright of HS Company Pty. Ltd.

## AIR COUPLINGS

### AIR LINE COUPLINGS

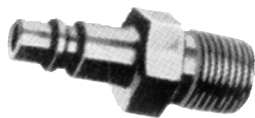

Figure 1



Figure 2



Figure 3

### MALE PLUGS

Part Number	Figure	Thread Details		Hose Size	Notes
		Size	Type		
PA602-4	1	1/4"	BSP - Male	-	
PA603-4	2	1/4"	BSP - Female	-	
PA604-4	3	-	-	1/4"	Barb type adaptor
PA604-5	3	-	-	5/16"	Barb type adaptor
PA602-6	1	3/8"	BSP - Female	-	
PA603-6	2	3/8"	BSP - Female	-	
PA604-6	3	-	-	3/8"	Barb type adaptor
PA602-8	1	1/2"	BSP - Male	-	
PA603-8	2	1/2"	BSP - Female	-	
PA604-8	3	-	-	1/2"	Barb type adaptor

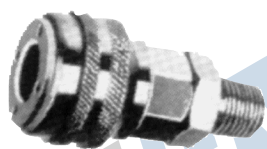

Figure 5

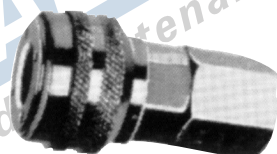

Figure 6

### FEMALE COUPLERS

Part Number	Figure	Thread Details		Hose Size	Notes
		Size	Type		
PA600-4	5	1/4"	BSP - Male	-	
PA601-4	6	1/4"	BSP - Female	-	
PA600-6	5	3/8"	BSP - Male	-	
PA601-6	6	3/8"	BSP - Female	-	
PA600-8	5	1/2"	BSP - Male	-	
PA601-8	6	1/2"	BSP - Female	-	

ALSO AVAILABLE IN NPT THREADS

‡ Pricing & availability on request. Minimum purchase quantity may apply.

www.mjhydraulic.com.au

Document No:	HSHYDCAT
Issue:	3
Issue Date:	01/09/2016

## TAIMI - LIVE SWIVELS

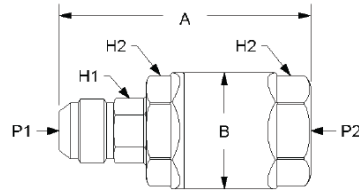

### STRAIGHT SWIVEL JOINTS - JIC M - UNO F

Part No.	A	B	P1 - JIC	P2 - UNO	H1	H2	Seal Kit
SZ-J08M-JB08F	3.31"	1.50"	3/4"-16 UNF	3/4"-16 UNF	1 1/16"	1 1/4"	SZ-08-001SK-A
SZ-J12M-JB12F	4.12"	2.00"	1 1/16"-12 UN	1 1/16"-12 UN	15/16"	1 5/8"	SZ-12-001SK-A
SZ-J16M-JB16F	4.63"	2.22"	1 5/16"-12 UN	1 5/16"-12 UN	1 3/16"	1 7/8"	SZ-16-001SK-A
SZ-J20M-JB20F	5.12"	2.75"	1 5/8"-12 UN	1 5/8"-12 UN	1 1/2"	2 3/8"	SZ-20-001SK-A
SZ-J24M-JB24F	5.34"	3.00"	1 7/8"-12 UN	1 7/8"-12 UN	1 3/4"	2 1/2"	SZ-24-001SK-A
SZ-J32M-JB32F	6.50"	3.88"	2 1/2"-12 UN	2 1/2"-12 UN	2 5/16"	3 1/4"	SZ-32-001SK-A

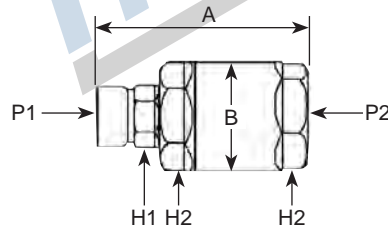

### STRAIGHT SWIVEL JOINTS - BSPP M-F

Part No.	A	B	P1 - BSPP	P2 - BSPP	H1	H2	Seal Kit
SZ-P08M-P08F	2.94"	1.53"	G 1/2	G 1/2	3/4"	1 5/16"	SZ-08-002SK-A
SZ-P12M-P12F	3.81"	2.00"	G 3/4	G 3/4	15/16"	1 5/8"	SZ-12-001SK-A
SZ-P16M-P16F	4.31"	2.22"	G 1	G 1	1 3/16"	1 7/8"	SZ-16-001SK-A
SZ-P20M-P20F	4.50"	2.75"	G 1 1/4	G 1 1/4	1 1/2"	2 3/8"	SZ-20-001SK-A

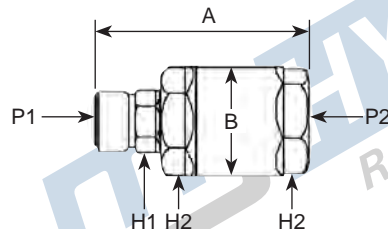

### STRAIGHT SWIVEL JOINTS - ORFS M-F

Part No.	A	B	P1 - ORFS	P2 - ORFS	H1	H2	Seal Kit
SZ-S08M-S08F	3.00"	1.53"	13/16"-16 UNF	13/16"-16 UNF	3/4"	1 5/16"	SZ-08-002SK-A
SZ-S12M-S12F	3.86"	2.09"	1 3/16"-12 UN	1 3/16"-12 UN	1 1/16"	1 3/4"	SZ-12-002SK-A
SZ-S16M-S16F	4.38"	2.31"	1 7/16"-12 UN	1 7/16"-12 UN	1 5/16"	2"	SZ-16-002SK-A
SZ-S20M-S20F	4.68"	2.75"	1 11/16"-12 UN	1 11/16"-12 UN	1 9/16"	2 3/8"	SZ-20-002SK-A

¥ Pricing & availability on request. Minimum purchase quantity may apply.

www.mjhydraulic.com.au

Document No:	HSHYDCAT
Issue:	3
Issue Date:	01/09/2016

This catalogue is the copyright of HS Company Pty. Ltd.

## TAIMI - LIVE SWIVELS

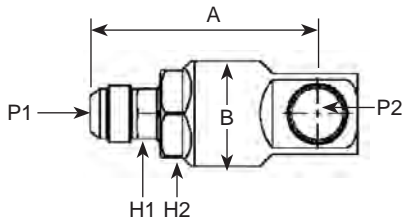

## 90° SWIVEL JOINTS - JIC M - UNO F

Part No.	A	B	P1 - JIC	P2 - UNO	H1	H2	Seal Kit
SZ90-J08M-B08F	3.34"	1.50"	3/4"-16 UNF	SAE 08	1 1/16"	1 1/4"	SZ-08-001SK-A
SZ90-J12M-B12F	4.26"	2.00"	1 1/16"-12 UN	SAE 12	15/16"	1 5/8"	SZ-12-001SK-A
SZ90-J16M-B16F	4.91"	2.22"	1 5/16"-12 UN	SAE 16	1 3/16"	1 7/8"	SZ-16-001SK-A
SZ90-J20M-B20F	5.71"	2.75"	1 5/8"-12 UN	SAE 20	1 1/2"	2 3/8"	SZ-20-001SK-A
SZ90-J24M-B24F	6.18"	2.97"	1 7/8"-12 UN	SAE 24	1 3/4"	2 1/2"	SZ-24-001SK-A
SZ90-J32M-B32F	7.59"	3.89"	2 1/2"-12 UN	SAE 32	2 5/16"	3 1/4"	SZ-32-001SK-A

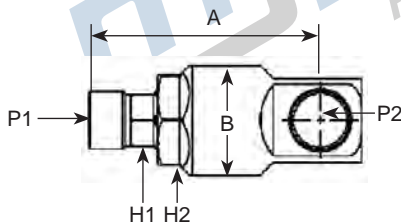

## 90° SWIVEL JOINTS - BSPP M - UNO F

Part No.	A	B	P1 - BSPP	P2 - UNO	H1	H2	Seal Kit
SZ90-P08M-B08F	3.22"	1.50"	G 1/2	SAE 08	3/4"	1 5/16"	SZ-08-002SK-A
SZ90-P12M-B12F	4.20"	2.00"	G 3/4	SAE 12	15/16"	1 5/8"	SZ-12-001SK-A
SZ90-P16M-B16F	4.84"	2.22"	G 1	SAE 16	1 3/16"	1 7/8"	SZ-16-001SK-A
SZ90-P20M-B20F	5.44"	2.75"	G 1 1/4	SAE 20	1 1/2"	2 3/8"	SZ-20-001SK-A

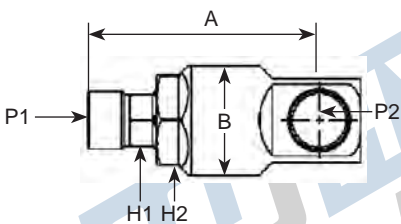

## 90° SWIVEL JOINTS - ORFS M - UNO F

Part No.	A	B	P1 - ORFS	P2 - UNO	H1	H2	Seal Kit
SZ90-S08M-B08F	3.22"	1.53"	13/16"-16 UNF	SAE 08	3/4"	1 5/16"	SZ-08-002SK-A
SZ90-S12M-B12F	4.20"	2.09"	1 3/16"-12 UN	SAE 12	1 1/16"	1 3/4"	SZ-12-002SK-A
SZ90-S16M-B16F	4.84"	2.31"	1 7/16"-12 UN	SAE 16	1 5/16"	2"	SZ-16-002SK-A
SZ90-S20M-B20F	5.44"	2.75"	1 11/16"-12 UN	SAE 20	1 9/16"	2 3/8"	SZ-20-002SK-A

www.mjhydraulic.com.au

Document No:	HSHYDCAT
Issue:	3
Issue Date:	01/09/2016

‡ Pricing & availability on request. Minimum purchase quantity may apply.



**TAIMI - LIVE SWIVELS**



**DUAL IN-LINE SWIVEL - JIC M - JIC M**

Part No.	A	B	P1 - JIC	P2 - UNO	H1	H2	Seal Kit
SM2A-J08-501 ¥	5.12"	1.50"	3/4"-16 UNF	3/4"-16 UNF	1 1/16"	1 1/4"	SZ-08-001SK-A
SM2A-J12-501	6.38"	2.00"	1 1/16"-12 UN	1 1/16"-12 UN	15/16"	1 5/8"	SZ-12-001SK-A
SM2A-J16-501 ¥	7.22"	2.25"	1 5/16"-12 UN	1 5/16"-12 UN	1 3/16"	1 7/8"	SZ-16-001SK-A
SM2A-J20-501 ¥	8.00"	2.75"	1 5/8"-12 UN	1 5/8"-12 UN	1 1/2"	2 3/8"	SZ-20-001SK-A

Note: Other configurations are available on request.

Live Swivels

www.mjhydraulic.com.au

Document No:	HSHYDCAT
Issue:	3
Issue Date:	01/09/2016

¥ Pricing & availability on request. Minimum purchase quantity may apply.

## TAIMI - LIVE SWIVEL CARTRIDGES

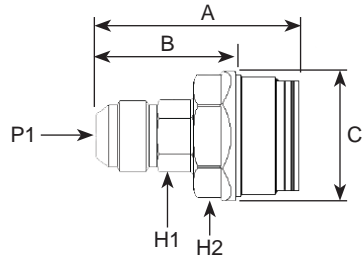

### MALE JIC

Part No.	A	B	C	P1 - JIC	H1	H2	Seal Kit
SZ4-06-J01M	1.90"	1.25"	1.13"	9/16"-18 UNF	1/2"	1"	SZ-06-001SK-A
SZ4-08-J01M	2.53"	1.50"	1.58"	3/4"-16 UNF	11/16"	1 1/4"	SZ-08-001SK-A
SZ4-12-J01M	3.15"	2.00"	1.95"	1 1/16"-12 UN	15/16"	1 5/8"	SZ-12-001SK-A
SZ4-16-J01M	3.63"	2.22"	2.38"	1 5/16"-12 UN	1 3/16"	1 7/8"	SZ-16-001SK-A
SZ4-20-J01M	3.96"	2.75"	2.55"	1 5/8"-12 UN	1 1/2"	2 3/8"	SZ-20-001SK-A
SZ4-24-J01M	4.17"	3.00"	2.68"	1 7/8"-12 UN	1 3/4"	2 1/2"	SZ-24-001SK-A
SZ4-32-J01M	5.03"	3.88"	3.28"	2 1/2"-12 UN	2 5/16"	3 1/4"	SZ-32-001SK-A

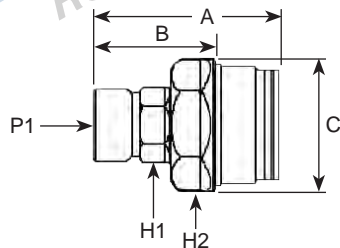

### MALE BSPP

Part No.	A	B	C	P1 - BSPP	H1	H2	Seal Kit
SZ4-06-P01M	1.81"	1.35"	1.05"	G 3/8	5/8"	1 1/4"	SZ-08-002SK-A
SZ4-08-P01M	2.36"	1.53"	1.39"	G 1/2	3/4"	1 5/16"	SZ-08-002SK-A
SZ4-12-P01M	3.00"	2.00"	1.86"	G 3/4	15/16"	1 5/8"	SZ-12-001SK-A
SZ4-16-P01M	3.50"	2.22"	2.25"	G 1	1 3/16"	1 7/8"	SZ-16-001SK-A
SZ4-20-P01M	3.63"	2.75"	2.25"	G 1 1/4	1 1/2"	2 3/8"	SZ-20-001SK-A

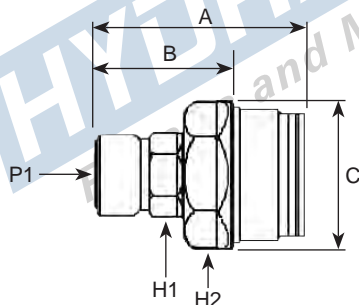

### MALE ORFS

Part No.	A	B	C	P1 - ORFS	H1	H2	Seal Kit
SZ1-08-S01M	2.41"	1.53"	1.44"	13/16"-16 UNF	3/4"	1 5/16"	SZ-08-002SK-A
SZ1-08-S01M	3.06"	2.09"	1.86"	1 3/16"-12 UN	1 1/16"	1 3/4"	SZ-12-002SK-A
SZ1-08-S01M	3.50"	2.31"	2.25"	1 7/16"-12 UN	1 5/16"	2"	SZ-16-002SK-A
SZ1-08-S01M	3.69"	2.75"	2.29"	1 11/16"-12 UN	1 9/16"	2 3/8"	SZ-20-002SK-A

www.mjhydraulic.com.au

Document No:	HSHYDCAT
Issue:	3
Issue Date:	01/09/2016

## INTERTRACO - LIVE SWIVELS

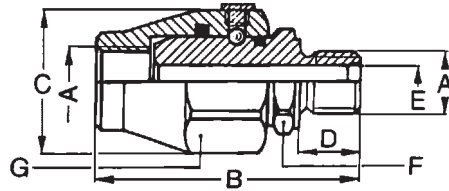

**SJ 10**



**SJ 10 (≥1")**

## STRAIGHT SWIVEL JOINTS - SERIES SJ

CODE	A	B	C	D	E	F	G	MAXIMUM PRESSURE IN ROTATION BAR	MAXIMUM PRESSURE BAR
SJ 10-04	1/4"	61	33	11	6.5	ES 19	ES 30	200	400
SJ 10-06	3/8"	66	47	14	9	ES 24	ES 34	200	400
SJ 10-08	1/2"	70	42	15	12	ES 27	ES 36	150	300
SJ 10-12	3/4"	79	50	19	16	ES 34	ES 45	150	300
SJ 10-16	1"	90	∅ 55	21	20	ES 41	CH 50	100	300
SJ 10-20	1-1/4"	101	∅ 60	24	28	ES 50	CH 55	100	300

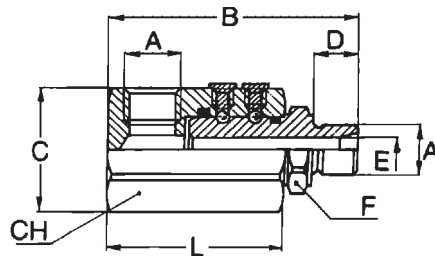

**SJ 90 (<1")**

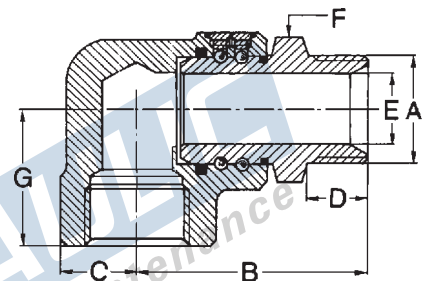

**SJ 90 (≥1")**

## 90° SWIVEL JOINTS - SERIES SJ

CODE	A	B	C	D	E	F	G	H	MAXIMUM PRESSURE IN ROTATION BAR	MAXIMUM PRESSURE BAR
SJ 90-04	1/4"	69	30.5	11	6.5	ES 19	58	ES 30	200	400
SJ 90-06	3/8"	78	41.5	14	9	ES 24	63	ES 36	200	400
SJ 90-08	1/2"	86	44	15	12	ES 27	68.5	ES 38	150	300
SJ 90-12	3/4"	99	58	19	16	ES 34	79	ES 50	150	300
SJ 90-16	1"	113	∅ 60	21	20	ES 41	90	∅ 60	100	300
SJ 90-20	1-1/4"	92	∅ 31.5	24	28	ES 50	56.5		100	300

www.mjhydraulic.com.au

Document No:	HSHYDCAT
Issue:	3
Issue Date:	01/09/2016

¥ Pricing & availability on request. Minimum purchase quantity may apply.

This catalogue is the copyright of HS Company Pty. Ltd.

**TAIMI TENSIONER**



**TENSIONER**

HARDY SPICER PART NUMBER	Length	Width	Height	Ports Qty x Thread	Notes
SM6T-J501S-00	16.00"	8 7/8"	15 3/8"	1 x JIC 3/4" 2 x JIC 7/8" 3 x JIC 1 1/16"	Suits Sandvik Jumbos

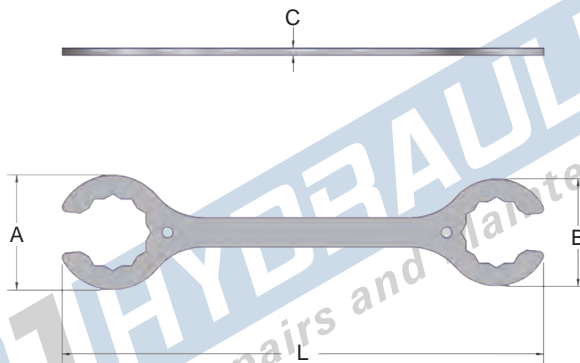

**TENSIONER SPANNER**

HARDY SPICER PART NUMBER	Head A	Head B	Thickness C	Length L
SK-1208-J01	2 7/8"	2 3/8"	3/16"	12"
SK-1210-J01	2 7/8"	2 11/16"	3/16"	12 1/8"

Live Swivels

Document No:	HSHYDCAT
Issue:	3
Issue Date:	01/09/2016

This catalogue is the copyright of HS Company Pty. Ltd.

## CIRCULAR & SPHERICAL JOINTS

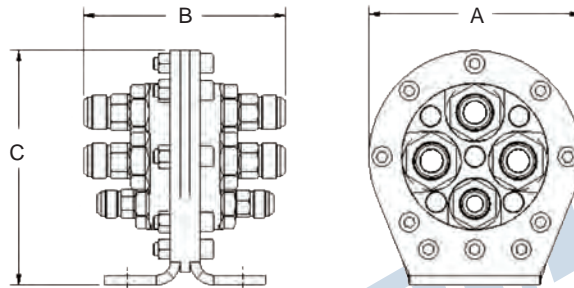

### CIRCULAR JOINTS

Part Number	A	B	C	Ports			Notes
				Qty x Thread	QTY x Thread	QTY x Thread	
SR4-JJ-501	8.00"	7.63"	8.88"	3 x JIC-1 5/16"	1 x JIC-1 1/16"		Various
SR4-JJ-501-7000	8.00"	7.63"	8.88"	2 x JIC-1 5/16"	1 x JIC-1 1/16"	1 x JIC-3/4"	Logmax 7000

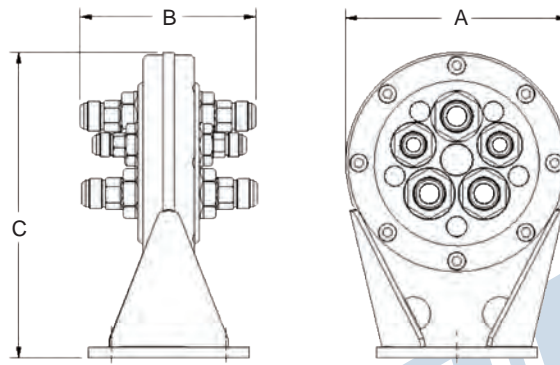

### SPHERICAL JOINTS

Part Number	A	B	C	Ports			Notes
				Qty x Thread	QTY x Thread	QTY x Thread	
SR5-JJ-501	9.66"	7.63"	13.25"	3 x JIC-1 5/16"	2 x JIC-1 1/16"		Various

www.mjhydraulic.com.au

Document No:	HSHYDCAT
Issue:	3
Issue Date:	01/09/2016

This catalogue is the copyright of HS Company Pty. Ltd.

**TAIMI MANIFOLDS**



SM2A-W6-501



SM2A-W6-514



SM2A-J12-501

**MANIFOLD**

HARDY SPICER PART NUMBER	Port Qty	Thread Configuration	Notes / Application
SM2A-J12-501	2	2 x 1 1/16" JIC	
SM2A-W6-501	4	2 x 1 5/16" JIC 2 x 1 1/16" JIC	Waratah 616, 622B, 624
SM2A-W6-506	4	2 x 1 5/16" JIC 2 x 1 1/16" JIC	Waratah 400
SM2A-W6-514	4	1 x 1 7/16" ORFS 1 x 1 5/8" JIC 2 x 1 1/16" JIC	Waratah 616, 622B, 624

**Note:** Other options and configurations are available on request.

Live Swivels

www.mjhydraulic.com.au

Document No:	HSHYDCAT
Issue:	3
Issue Date:	01/09/2016

**NOTES**

Live Swivels



[www.mjhydraulic.com.au](http://www.mjhydraulic.com.au)

Document No:	HSHYDCAT
Issue:	3
Issue Date:	01/09/2016

This catalogue is the copyright  
of HS Company Pty. Ltd.

**NOTES**

**MJ HYDRAULIC**  
Repairs and Maintenance

**MJ HYDRAULIC**  
Repairs and Maintenance

Live Swivels

[www.mjhydraulic.com.au](http://www.mjhydraulic.com.au)

Document No:	HSHYDCAT
Issue:	3
Issue Date:	01/09/2016